

Bent levers

Steel / Stainless Steel / Zinc / Aluminum

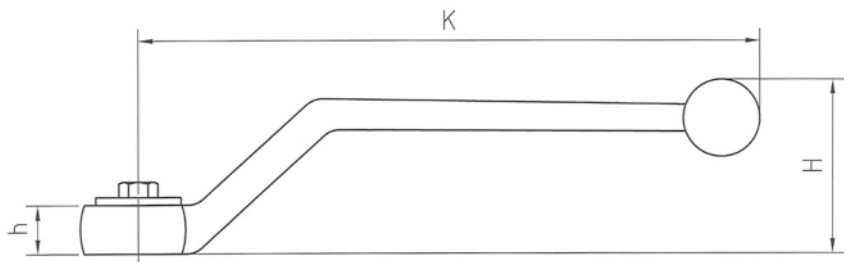

DIMENSIONS				ORDER CODE PER MATERIAL					
SW	K	h	H	Weight [Kg]	Steel	Weight [Kg]	Stainless Steel	Weight [Kg]	Zinc
7	80	6,5	30	0,05	013 00196*			0,03	013 12603*
7	60	6,5	22			0,04	013 26305*		
9	115	8,7	45					0,09	013 15533*(1)
9	115	9	47	0,10	013 00063*(1)	0,10	013 14689*(1)		
14	171	12	64	0,25	013 08618*(1)				
14	160	12	48			0,20	013 49334*(1)		
17	306	16	89	0,70	013 14083*				
17	227,5	15	90			0,40	013 32962*		

(1) Article numbers include flow indicator for 2-way valves.
Article numbers for multiway valves on request

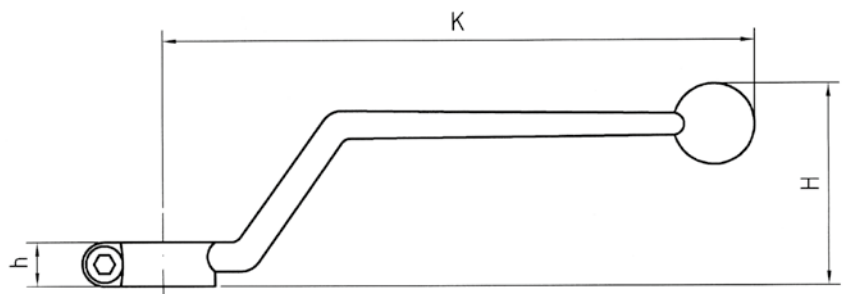

DIMENSIONS				ORDER CODE PER MATERIAL	
SW	K	h	H	Weight [Kg]	Aluminum
12	160	12	55	0,07	013 01741*

*Article usually in stock.